

**Soft Flex.**

# Knitting with a Knitting Spool

Change your design by choosing a different style of knitting or size of spool. You can also use different Soft Flex® wire colors, beading wire diameters or gauges of Soft Flex® Craft Wire as well as threads, cords, yarns and leathers. Add beads and weave multiple different materials together to create unique, one-of-a-kind jewelry.



Design by Sara Oehler



## Step 1

String the wire down through the center of the knitting spool and use your hand to hold the tail down.



## Step 2

Notice that I numbered each pin on the spool in a counter clockwise fashion. Wrap the wire around Pin 1 from left to right (clockwise).

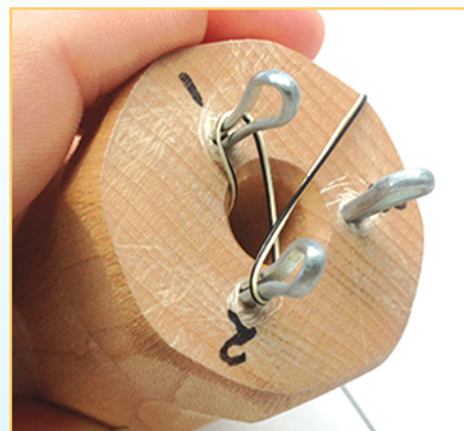

## Step 3

Wrap the wire around Pin 2 (counterclockwise from Pin 1) from left to right (clockwise).

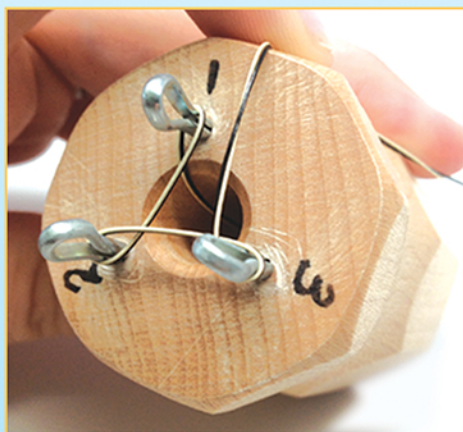

## Step 4

Wrap the wire around Pin 3 from left to right.



## Step 5

Wrap the wire around the outside and top of Pins 1, 2 and 3. The new wire should wrap above the loops that are already positioned on the pins.



## Step 6

Wrap the wire around the outside and top of Pin 1 (this is a third pass).

*Instructions continued on next page.*



#### Step 7

Using the stylus, take the loop at the bottom of Pin 1 and pull it up over the wires wrapped above it and into the middle of all 3 pins.



#### Step 8

Once the wire loop is in the middle of all 3 pins, give a gentle tug from the bottom.



#### Step 9

Repeat Steps 6-8 on Pins 2 and 3. Continue this pattern until your knitted cord is the length that you prefer.

## Finishing a Knitted Design



Step 1

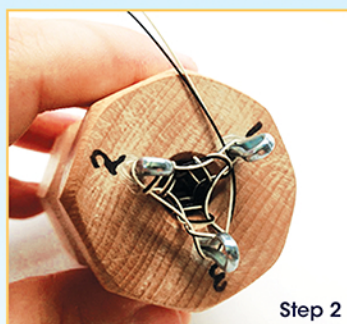

Step 2



Step 3

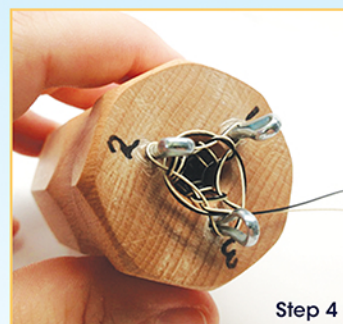

Step 4

**Step 1:** After you have knitted your desired length, the knitted wire cord will come out of the bottom of the spool. When you are ready to finish your design, trim the wire about 3 inches long.

**Step 2:** String the wire through the loop around Pin 1.

**Step 3:** String the wire through the loop around Pin 2.

**Step 4:** String the wire through the loop around Pin 3.



Step 5



Step 6

**Step 5:** Pull each loop off of each pin.

**Step 6:** Pull the knitted wire chain out of the knitting spool and cinch down the end by pulling on the wire. The end loops will not be perfect in size.



Join

*SoftFlex Company*<sup>LLP</sup>

**LIVE ON FACEBOOK**

with Sara Oehler

[www.facebook.com/SoftFlexWire](http://www.facebook.com/SoftFlexWire)



Subscribe to our YouTube Channel  
for regular video tutorials!

[www.youtube.com/c/SoftFlexCompany](http://www.youtube.com/c/SoftFlexCompany)